

EVACUATION PLAN

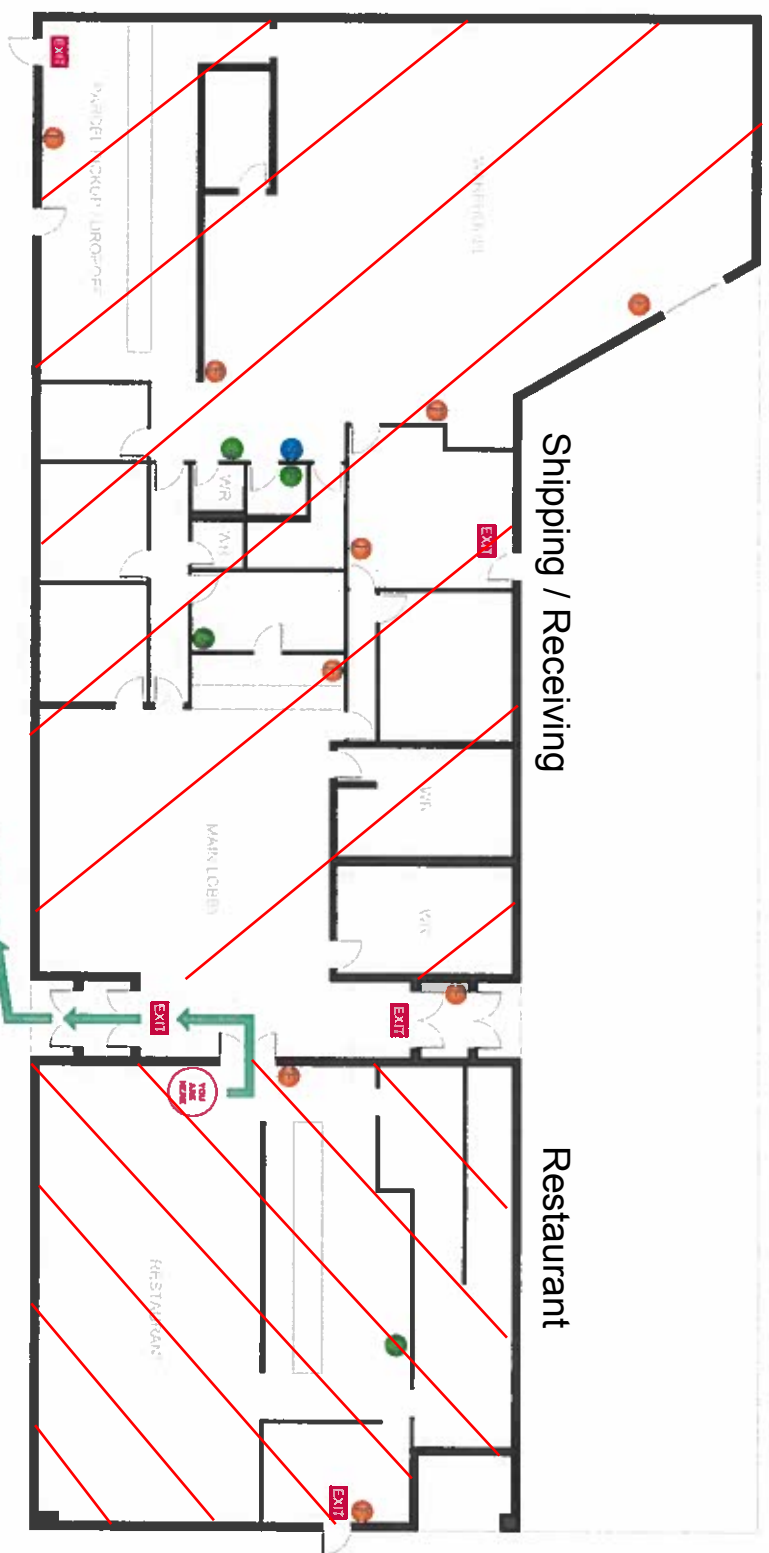

"EMERGENCY ASSEMBLY AREA"
GREYHOUND SIGN

Greyhound
 Building Owner: GREYHOUND CANADA
 Date: January 27, 2018
 Prepared By: K & B Speak
 Greyhound Bus Depot, 815 Fort William Road, Thunder Bay, Ontario

LEGEND:







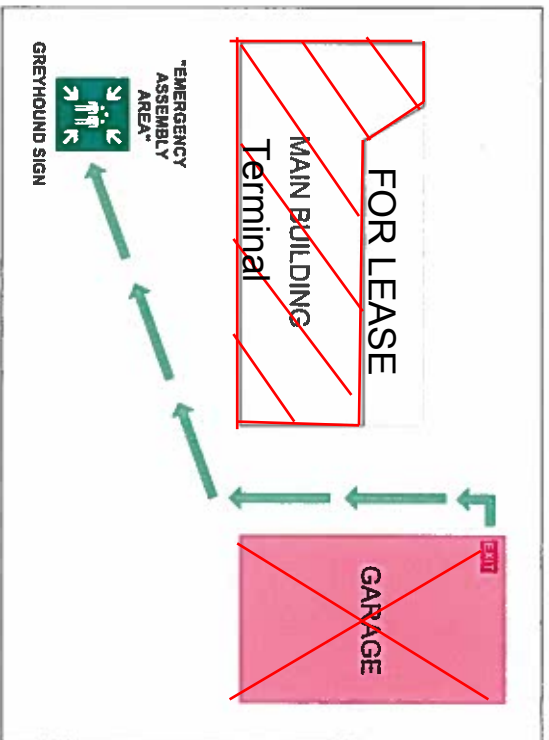



- EMERGENCY EXIT ROUTE
- EMERGENCY ASSEMBLY AREA
- YOU ARE HERE
- FIRE EXTINGUISHER
- FIRST AID KIT
- SAFETY DATA SHEETS
- EYEWASH STATION
- DESIGNATED EXIT

EVACUATION PLAN

EVACUATION SITE PLAN



LEGEND:

	EMERGENCY EXIT ROUTE		FIRE EXTINGUISHER
	EMERGENCY ASSEMBLY AREA		FIRST AID KIT
	YOU ARE HERE		SAFETY DATA SHEETS
	DESIGNATED EXITS		EYEWASH STATION
			SPILL KIT
			HAZARDOUS WASTE CONTAINER

 Prepared by K & B Speak	Building Owner GREYHOUND CANADA	Date January 27, 2018
	Greyhound Bus Depot 815 Fort William Road, Thunder Bay, Ontario	

